

Parts Diagram

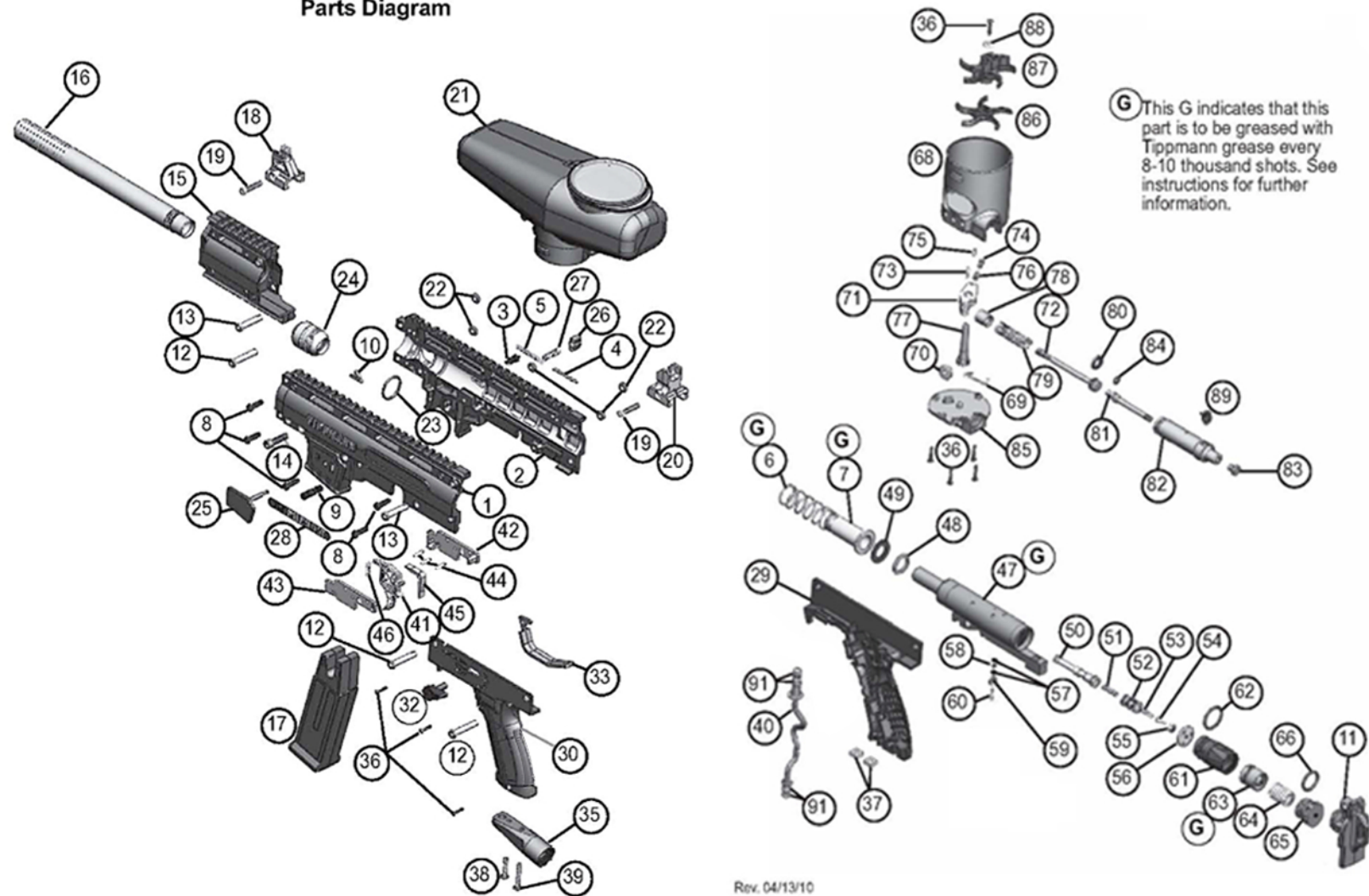

G This G indicates that this part is to be greased with Tippmann grease every 8-10 thousand shots. See instructions for further information.

Rev. 04/13/10

Phenom Marker Parts List

ITEM NO.	PT. NO.	DESCRIPTION	ITEM NO.	PT. NO.	DESCRIPTION	ITEM NO.	PT. NO.	DESCRIPTION
1	TA30043	Receiver, Left Half	32	TA30103	Selector Switch	62	TA30040	O-ring
2	TA30044	Receiver, Right Half	33	02-38	Trigger Guard	63	TA30104	Regulator Piston Assembly
3	TA30027	CFS Hose Fitting Assembly	35	TA30015	Air Supply Adapter (ASA)	64	TA30031	Compression Spring
4	TA05016	Hose, 5/16" ID x 1 1/2"	36	PL-42A	Screw, #4 x 5/8" Black	65	TA30022	Velocity Adjuster
5	TA30057	Compression Spring	37	CA-08B	Nut, 10-32 Square MS	66	TA30054	O-ring
6	TA30003	Compression Spring	38	PL-01A	Screw, BHCS	67	TA30046	Cyclone Feed System Assembly Complete
7	TA30101	Front Bolt Assembly	39	98-06A	Screw, BHCS	68	02-43	Feeder Housing
8	98-01A	Screw, LSHCS	40	TA30045	Gas Line Assembly	69	02-50	Feeder Ratchet Spring
9	TA30016	Pressure Gauge Plug Assembly	41	TA30100	Trigger Assembly	70	02-42	1/4" - 20 Flange Nut
10	FA-18	Ball Latch	42	TA30008	Trigger Plate, Right	71	02-53	Feeder Ratchet
11	TA10038	End Cap	43	TA30007	Trigger Plate, Left	72	02-54	Feeder Cylinder Piston
12	TA10045	Push Pin Assembly	44	02-33	Dowel Pin,	73	02-52L	Dowel Pin, 3/32 OD x 7/16"
13	02-PIN	Push Pin Assembly	45	TA30013	Trigger Lever	74	TA01260	Compression Spring
14	02-41	1/4" - 20 UNC x 1" SHCS	46	02-88	Compression Spring	75	02-52S	Dowel Pin, 3/32 OD x 5/16"
15	TA30047	Front Grip/Shroud Assembly	47	TA30024	Valve Body, Machined	76	02-51	Ratchet Spring Guide
16	TA30041	Barrel	48	TA30018	Spacer Washer	77	02-49	Feeder Axle
17	TA30004	Magazine	49	TA20077	Bumper Disk	78	02-64	Feeder Cylinder Plug
18	TA06061	Front Sight Assembly	50	TA30038	Firing Spool Complete	79	02-66	Compression Spring
19	TA07065	Bolt	51	TA30030	Compression Spring	80	02-63	Piston U-Cup Seal
20	TA06041	Rear Sight Assembly	52	TA30020	Valve Spool Spacer Complete	81	02-65	Feeder Reset Rod
21	TA10042	Hopper Assembly	53	02-88	Compression Spring	82	TA10034	Feeder Cylinder
22	9-PA	Hex Nut, Black	54	TA30028	Regulator Pin	83	02-61	Feeder Reset Button
23	TA20046	O-ring	55	TA20075	Regulator Pin Seal	84	SL2-6	O-Ring
24	02-69	Barrel Adapter Assembly	56	TA30025	Regulator Seat	85	02-44	Feeder Bottom Plate
25	TA30006	Magazine Release Pin	57	TA20008	O-Ring, C.U., 70A, 2-003	86	TA30012	Lower Feeder Sprocket
26	TA30009	Magazine Release Button	58	TA30036	Valve Core	87	TA30011	Upper Feeder Sprocket
27	TA30032	Compression Spring	59	TA30037	Trigger Pin Plug	88	02-48	#4 Flat Washer
28	TA30042	Name Plate	60	TA30039	Trigger Pin	89	20-07	Banjo Fitting Assembly
29	TA30061	Lower Receiver, Right (Mechanical model)	61	TA30026	Regulator Body	91	TA30049	O-Ring, Gas Line
30	TA30060	Lower Receiver, Left (Mechanical model)						